

- 1) Turn off the spa and unplug the power cord from the electrical socket.
- 2) Unscrew the filter cartridge assembly from the spa tub wall, and use the included plugs to cover the water inlet and outlet fittings from inside of the spa tub to prevent water from flowing out. Disconnect the spa control unit from the spa tub and use the included plugs to cover the water inlet and outlet fittings from outside of the spa tub to prevent water from flowing out.
- 3) Remove the four screws from the transparent cover using a Phillips screwdriver (not included) and remove the cover from the spa control unit.

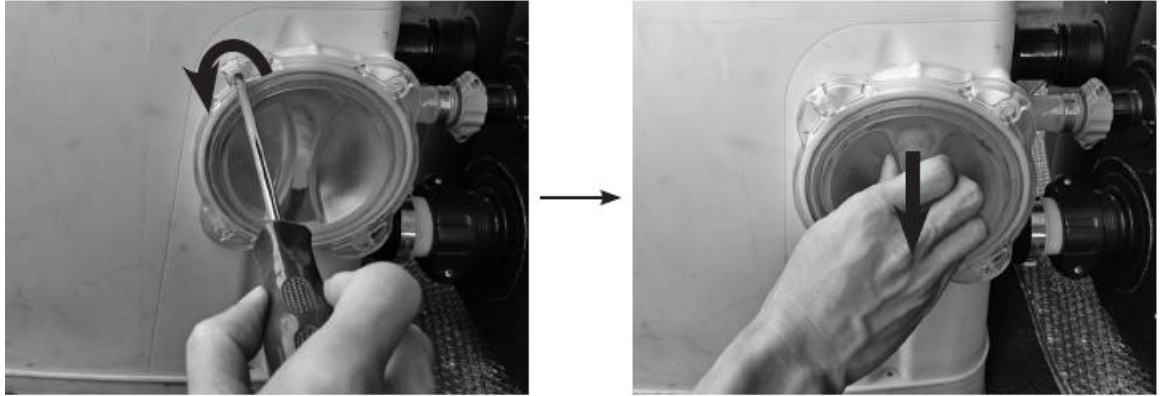

- 4) Unplug the electrolytic cell cord. Unscrew the electrolytic cell nut in a counter-clockwise motion using the included electrolytic cell nut wrench

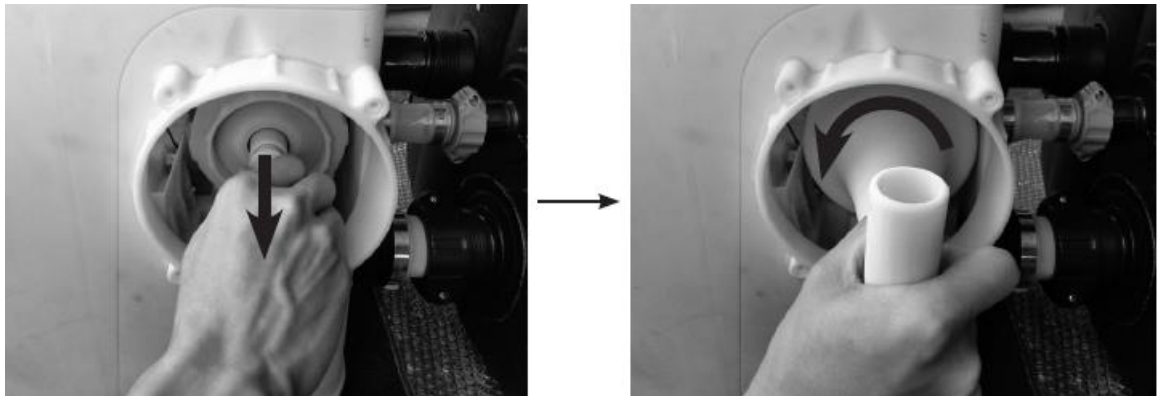

- 5) Pull out the electrolytic cell and place it in a container, pour kitchen grade vinegar into the container to soak the titanium plate for about one hour until no deposits remain.

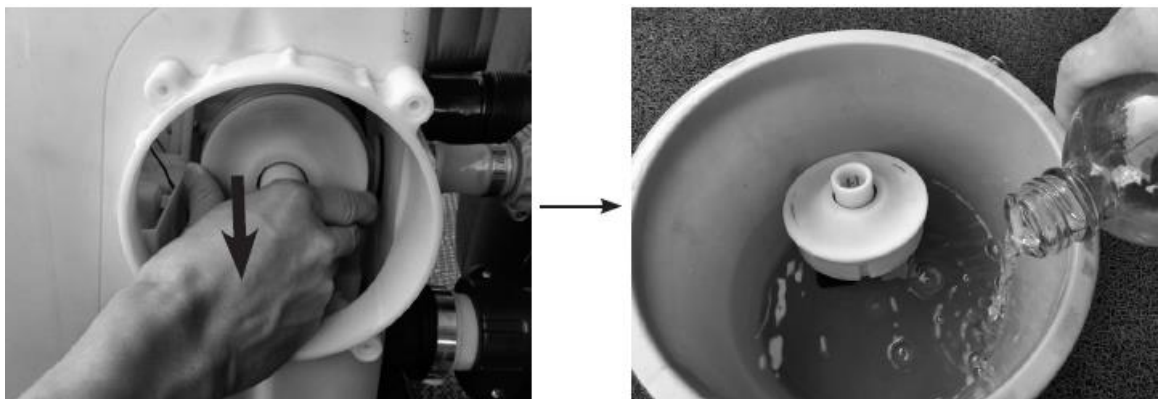

- 6) Remove the electrolytic cell and flush the titanium plate with fresh water. Be

careful: Keep the electrolytic cell receptacle completely dry, do not let it come into contact with the vinegar and water.

- 7) Reverse the above steps to reinstall the electrolytic cell.

NOTE: Ensure the notch on the electrolytic cell is aligned with the ridge on the electrolytic cell housing.